

Circular measuring and adjustment damper

ZMC

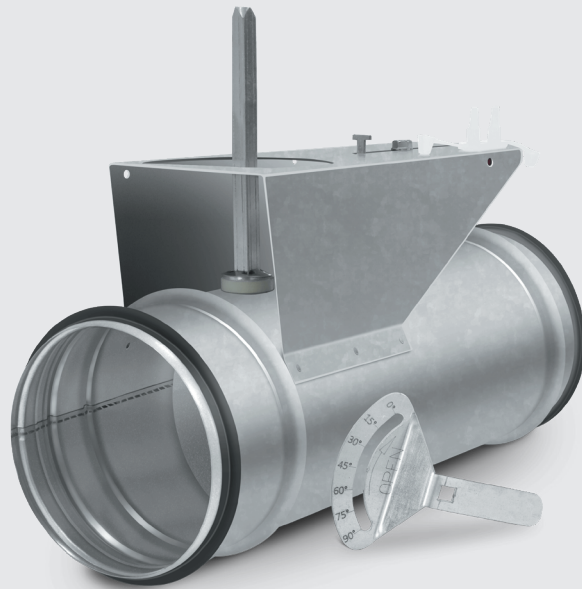

### Description

The ZMC is a circular damper which can be used to regulate the air volume by adjusting the damper blade. The damper blade is not perforated.

The measuring pins are extended with an intermediate plastic tube long enough to allow measurement and movement from one location.

ZMC is made with manual positioning screws.  
Measurement accuracy:  $\pm 5\%$ .

### Standard sizes

100, 125, 160, 200, 250, 315, 400, 500 and 630 mm  
Available in other sizes on request.

### Material

The butterfly valve, the handle and the regulating butterfly are made of galvanized sheet steel and EPDM rubber, the measuring flange is made of aluminum.

### Main features

- control and measuring unit
- can be used in hard-to-reach places

### T.1. Quick selection

Type	3 m/s* l/s [m <sup>3</sup> /h]	5 m/s* l/s [m <sup>3</sup> /h]
100	25 [90]	40 [144]
125	40 [144]	60 [216]
160	60 [216]	100 [360]
200	100 [360]	150 [540]
250	150 [540]	250 [900]
315	250 [900]	400 [1440]
400	400 [1440]	600 [2160]
500	600 [2160]	1000 [3600]
630	1000 [3600]	1500 [5400]

\* for air volume

## Noise level data

### T.2. Correction $K_o$ [dB]

Típus	Medium frequency (Hz)							
	63	125	250	500	1000	2000	4000	8000
100	-22	-9	0	-2	-4	-11	-21	-35
125	-16	-7	-1	-2	-4	-10	-19	-33
160	-16	-8	-2	-2	-4	-9	-18	-35
200	-17	-10	-4	-4	-3	-8	-15	-30
250	-7	-9	-3	-3	-4	-8	-14	-30
315	-3	-7	-2	-2	-5	-9	-17	-31
400	-1	-7	-4	-2	-5	-8	-13	-26
500	+1	0	0	-2	-4	-12	-19	-32
630	+5	+1	+1	-3	-5	-10	-17	-30

Tol.  $\pm 3$  dB

The soundlevel is applicable at an equivalent sound absorption area of 10 m<sup>2</sup>.

Sound power level:  $L_w$  [dB]

Sound pressure level:  $L_{PA}$  [dB(A)] (see diagram 1-9.)

Correction factor:  $K_o$  [dB]

Correction factor  $KO$ [dB] from table 2.

$$L_w = L_{PA} + K_o$$

### T.3. C factor

Size ( $\varnothing$ )	C factor
100	6,35
125	9,8
160	16
200	26,2
250	39,3
315	62,8
400	106
500	158
630	268

Formula:

$$q_v = K * \sqrt{p}$$

$$q_v = l/s, p=Pa$$

## Mounting

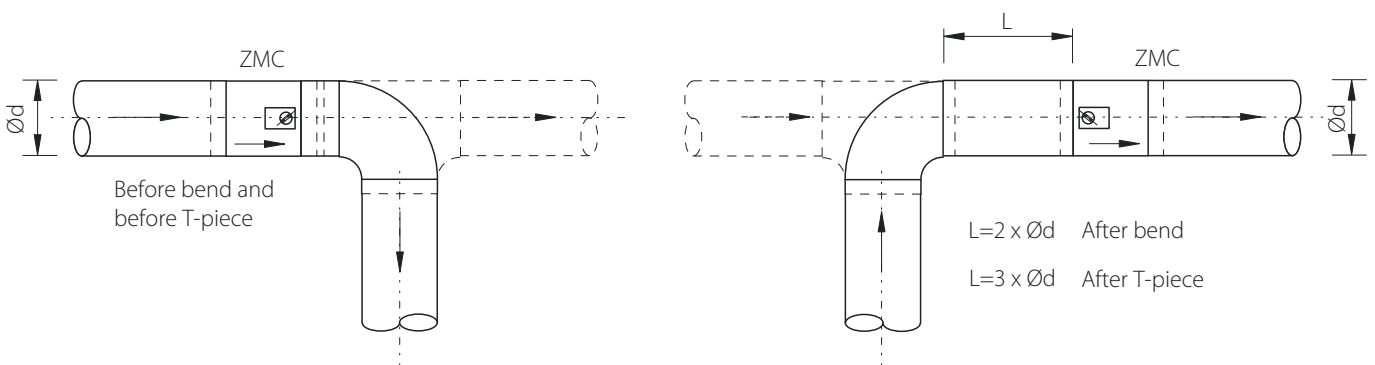

$P_a$  = Static pressure drop

## Diagrams

**D.1.**  
ZMC-100

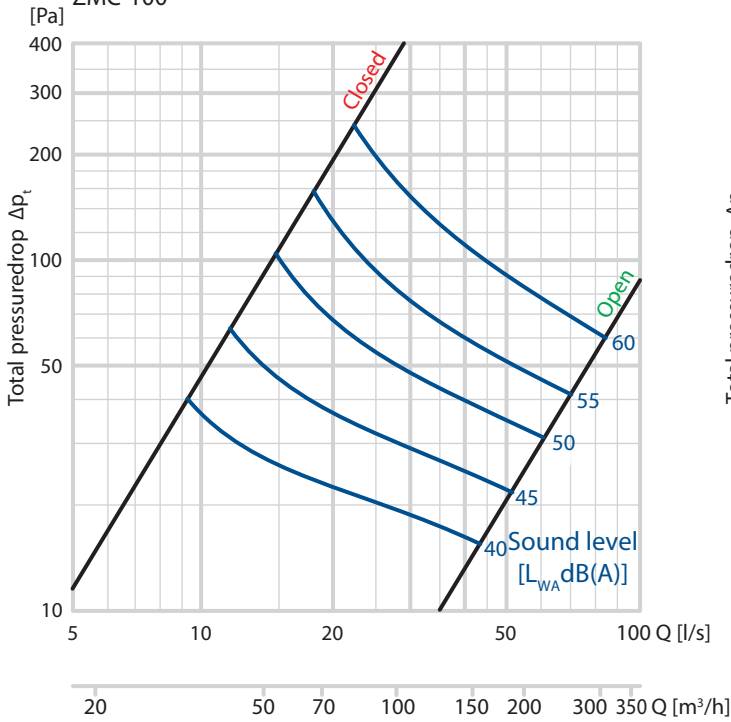

**D.2.**  
ZMC-125

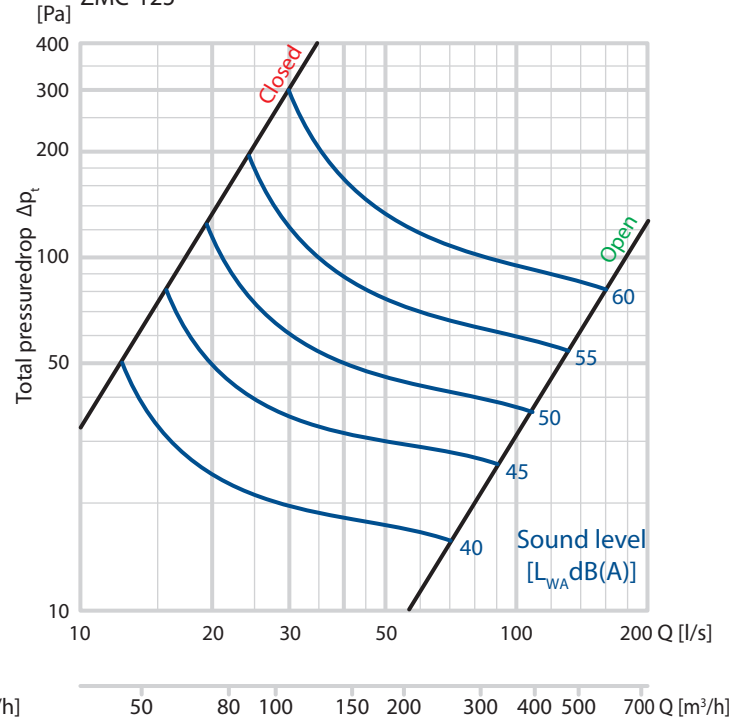

**D.3.**  
ZMC-160

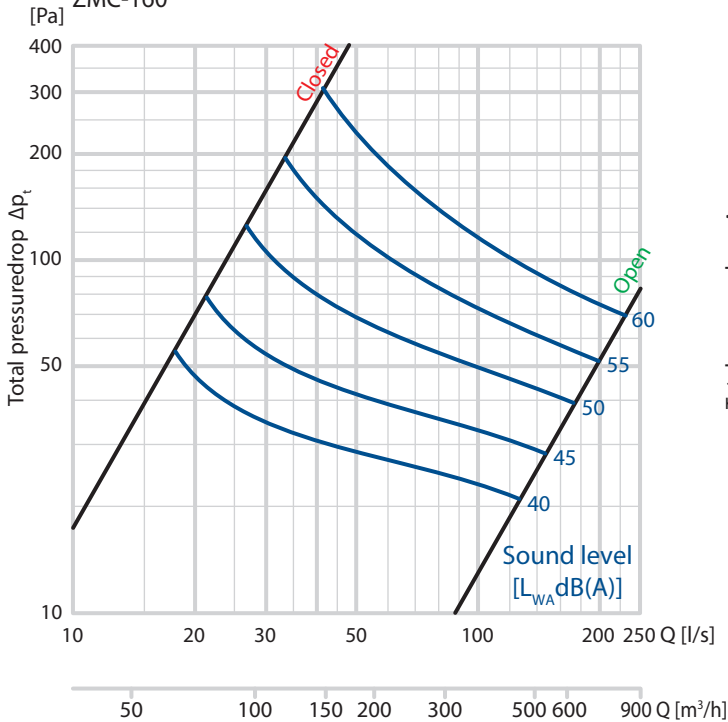

**D.4.**  
ZMC-200

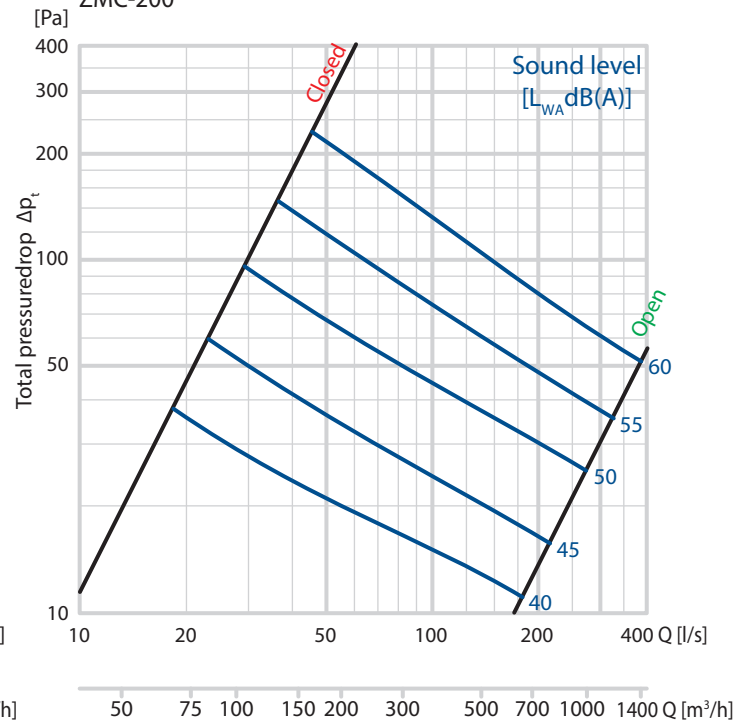

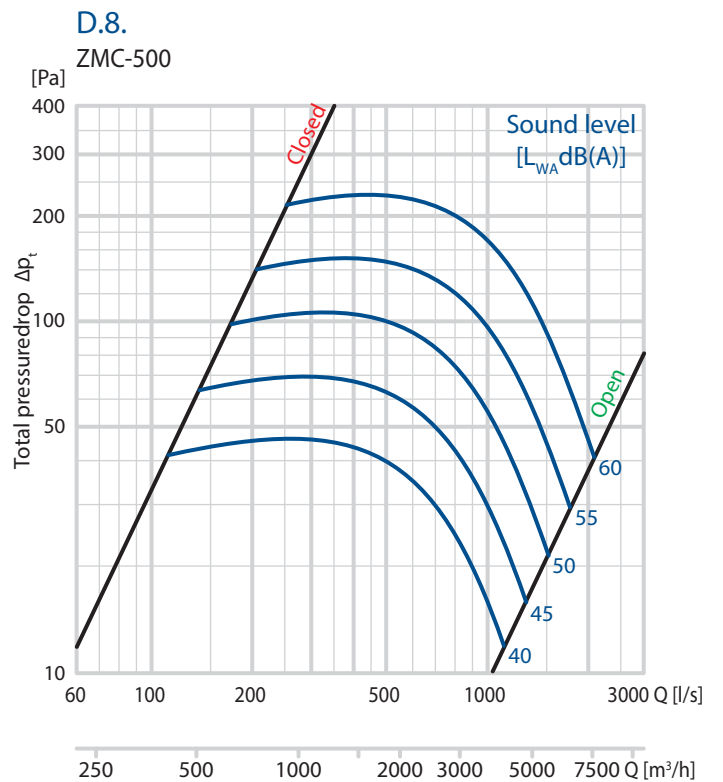
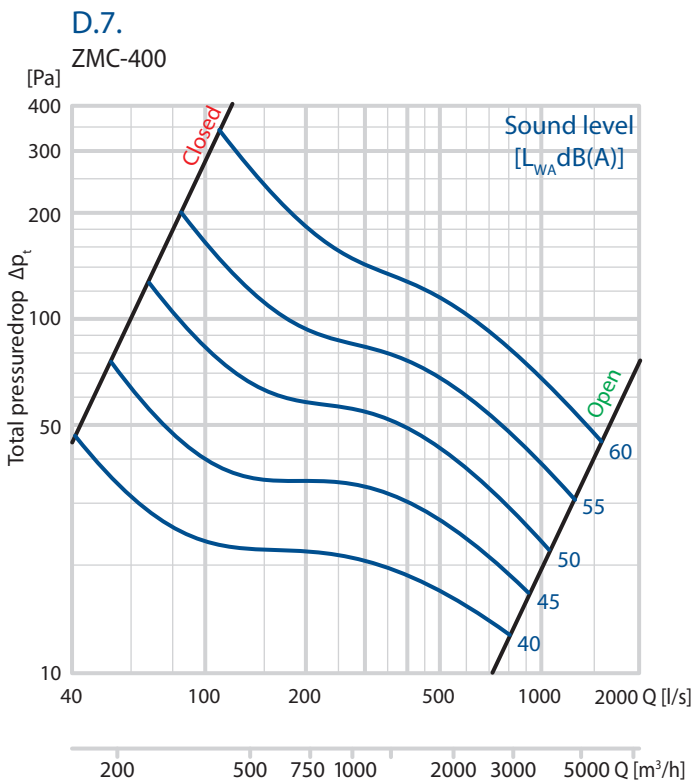
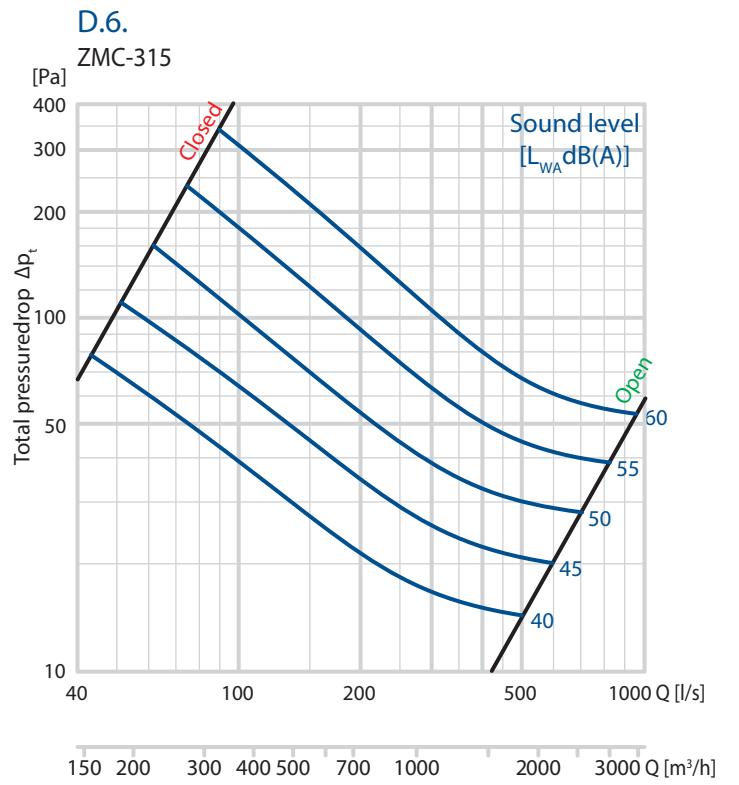
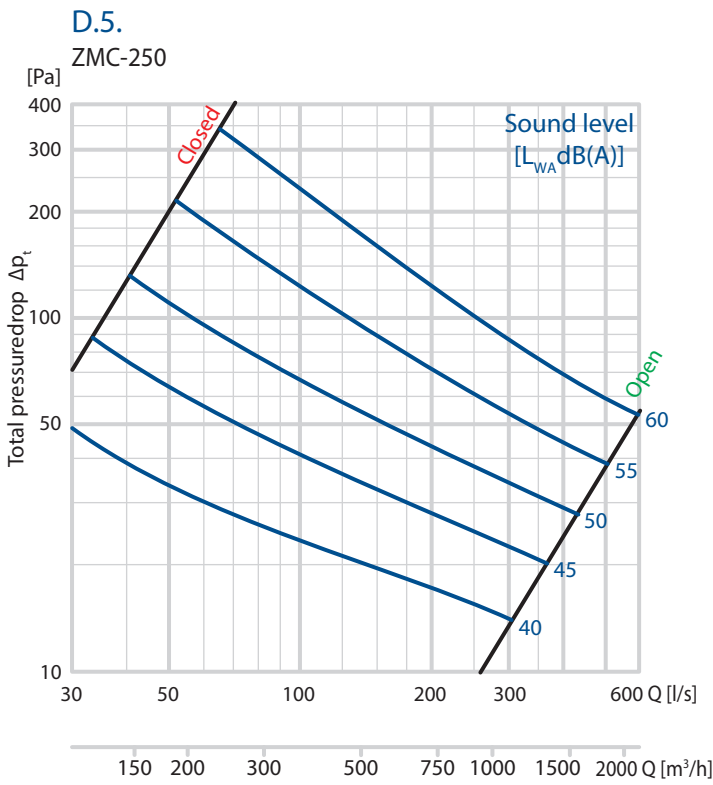

### D.9.

ZMC-630

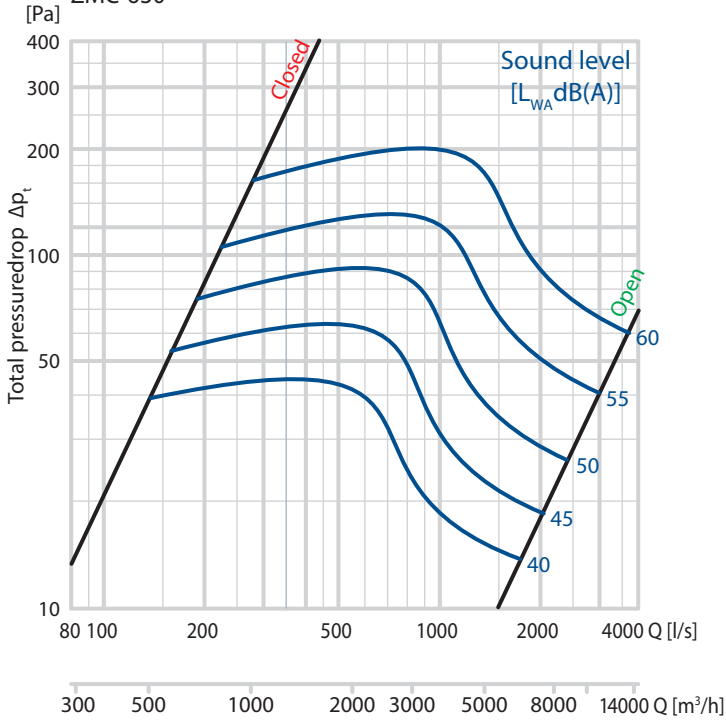

## Dimensions

### T.4.

Type	ØD	L (±5)	L1	Weight [kg]
100	99	287	217,3	0,85
125	124	296	228	1,01
160	159	316	236,6	1,23
200	199	336	268	1,55
250	249	445	337	2,25
315	314	553	445	3,51
400	399	698	548	6,08
500	499	827	677	8,84
630	629	837	687	12,96

The indicated sizes are shown in mm.

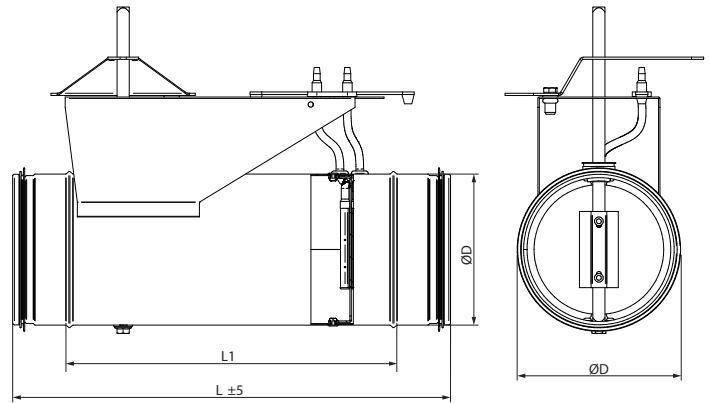

## Specification

Ordering code:	ZMC -XXX
Product acronym:	ZMC
Size (Ø):	100 125 160 200 250 315 400 500 630
Example: ZMC-250	